



HTL Low Profile Torque Wrench Attachment

The HTL Low Profile Torque Wrench Attachment is part of HTL's innovative 3-in-1 Hydraulic Torque Wrench range and works with HTL's range of 'W' Low Profile Hydraulic Torque Wrenches.

Due to its innovative design and the high quality materials used, this is extremely durable and easy to operate. With hex sizes available from $\frac{3}{4}$ " to $6\frac{1}{8}$ " AF, 19mm to 155mm AF and torque range from 255 to 31,800 ft.lb, 346 to 43,100 Nm the HTL Low Profile Torque Wrench Attachment is suitable for a wide range of applications where clearance is limited.

Interchangeable & Cross Compatible Design

The design ensures that the operator can interchange ratchet links with many other well-known brands (specifically Hystorc, Rapid-Torc and Atlas Copco).

Features and Benefits

- ✓ Fully interchangeable with many other well-known brands (Hystorc, Rapid-Torc and Atlas Copco)
- ✓ Made in the UK
- ✓ Calibrated and accurate to +/- 3%
- ✓ Only 3 moving parts for reliability and maintenance
- ✓ Hex sizes available from $\frac{3}{4}$ " to $6\frac{1}{8}$ " AF, 19mm to 155mm AF
- ✓ Non-standard link sizes available



*Complete tool shown is HTL-W Torque Wrench with HTL-L Low Profile Attachment

Technical Information

| Model | | HTL-L2 | HTL-L4 | HTL-L8 | HTL-L14 | HTL-L30 |
|----------------------|--------------|-----------------------------------|-----------------------------------|-------------------------------------|-------------------------|--------------------------------------|
| Torque Wrench | | HTL-W2 | HTL-W4 | HTL-W8 | HTL-W14 | HTL-W30 |
| Min Torque | lb.ft | 255 | 580 | 1143 | 2010 | 4770 |
| | Nm | 346 | 786 | 1549 | 2725 | 6466 |
| Max Torque | lb.ft | 1710 | 3855 | 8151 | 13400 | 31800 |
| | Nm | 2318 | 5226 | 11049 | 18165 | 43100 |
| Weight | Kg | 0.93 | 1.86 | 3.22 | 5.12 | 11.28 |
| A | mm | 183 | 248 | 308 | 372 | 406 |
| | Inch | 7.2 | 9.8 | 12.1 | 14.6 | 16.0 |
| B | mm | 24-70 | 36-80 | 50-105 | 55-120 | 70-155 |
| | Inch | $\frac{3}{4}'' - 2 \frac{3}{4}''$ | $\frac{7}{8}'' - 3 \frac{1}{8}''$ | $1 \frac{3}{4}'' - 4 \frac{1}{8}''$ | $2'' - 4 \frac{5}{8}''$ | $3 \frac{9}{16}'' - 6 \frac{1}{8}''$ |
| C | mm | 9 | 12 | 15 | 18.5 | 22 |
| | Inch | 0.4 | 0.5 | 0.6 | 0.7 | 0.9 |
| D | mm | 31.5 | 42 | 52.6 | 64 | 85 |
| | Inch | 1.2 | 1.7 | 2.1 | 2.5 | 3.3 |
| E | mm | 45 | 60 | 80 | 90 | 131 |
| | Inch | 1.7 | 2.4 | 3.1 | 3.5 | 5.2 |

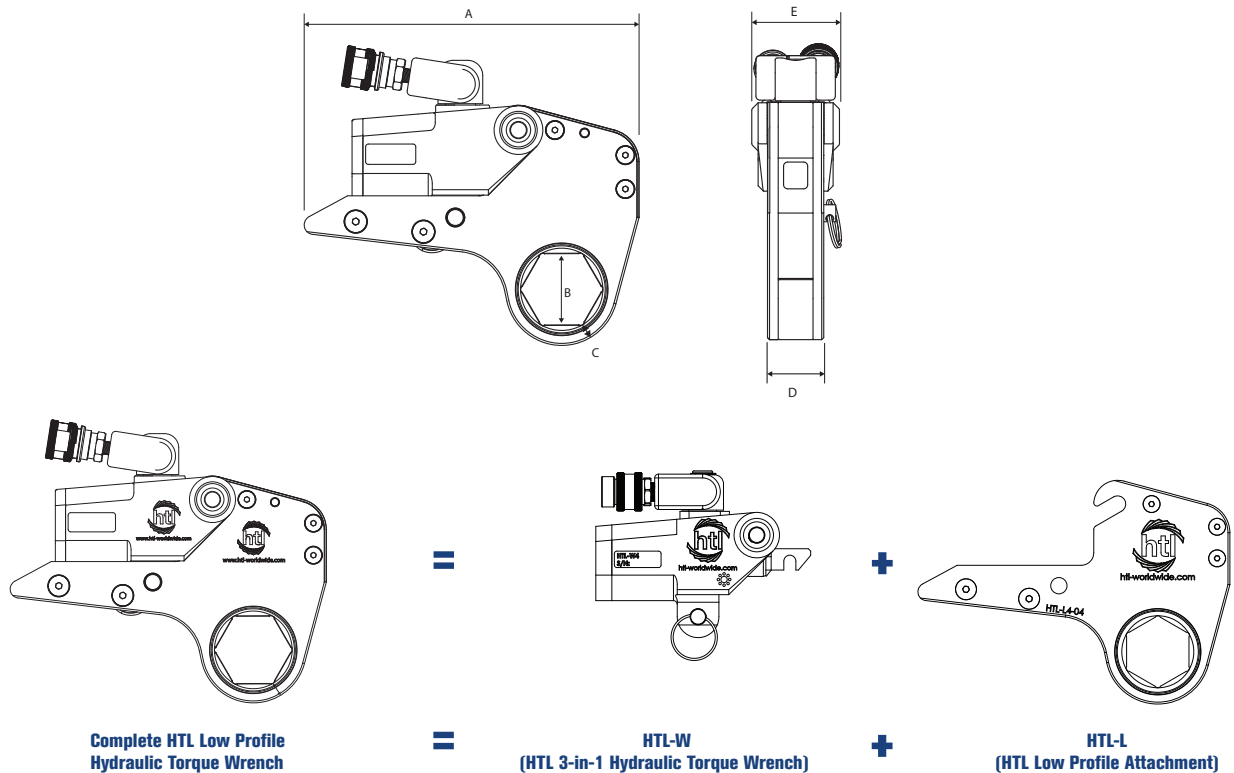

PLEASE NOTE: Figures provided are for guidance only, please refer to individual tool charts. All data is given in good faith and without acceptance of responsibility on the part of HTL.

INDUSTRY LEADERS IN CONTROLLED BOLTING, FLANGE WORKING AND PORTABLE MACHINE SOLUTIONS



Hire Torque Ltd
 45 Colbourne Avenue,
 Nelson Park Industrial Estate,
 Cramlington, Northumberland,
 NE23 1WD

Telephone: +44 (0) 1670 700 000
 Email: info@hiretorque.com
 Visit: www.hiretorque.com

