



# DSX Square Drive Torque Wrench

Designed with both operator and job site safety at the forefront, the DSX range includes patented industry first features.

Reducing DROPS from height incidents, the DSX range includes a fully retained reaction arm, which remains connected to the tool whilst it is adjusted, as well as a working at height connection point.

Other features include a multi direction stainless steel hose swivel, a high strength, high cycle design, and a HTL safety handle supplied as standard.

## Features and Benefits

- ✓ Patented, easy to use quick release, retained reaction arm
- ✓ Supplied with an ergonomic safety handle as standard
- ✓ Multi direction 360 x 180 high flow stainless steel hose swivel
- ✓ Compact nose radius for tight locations
- ✓ Reduced operating costs with high cycle design with fewer moving parts
- ✓ Fine tooth ratchet prevents the tool 'locking on'
- ✓ Fully enclosed drive for maximum operator safety
- ✓ High strength, low weight, slimline, unibody design
- ✓ Push button quick release, reversible square drive
- ✓ Wide range of accessories available
- ✓ Made in the UK
- ✓ Models from  $\frac{3}{4}$ " sq drive to 2  $\frac{1}{2}$ " sq drive.
- ✓ Tool accuracy +/- 3%
- ✓ Supplied in a robust storage case
- ✓ Long stroke piston ensures a high degree of nut rotation



# Technical Information

Model		HTL-DSX1	HTL-DSX3	HTL-DSX5	HTL-DSX10	HTL-DSX25
Square Drive Size		$\frac{3}{4}"$	1"	$1\frac{1}{2}"$	$1\frac{1}{2}"$	$2\frac{1}{2}"$
Min Torque	ft.lb	200	480	835	1755	3960
	Nm	271	651	1132	2379	5368
Max Torque	ft.lb	1340	3230	5590	11520	25890
	Nm	1817	4379	7578	15617	35096
Weight	kg	1.9	4.3	7.4	13	32.5
A	mm	124	161	180	221	283
	Inch	4.9	6.3	7.1	8.7	11.1
B	mm	190	251	303	379	498
	Inch	7.5	9.9	11.9	14.9	19.6
C	mm	125	163	197	249	322
	Inch	4.9	6.4	7.8	9.8	12.7
D	mm	172	230	276	344	458
	Inch	6.8	9.0	10.8	13.6	18.0
E	mm	44	58	69	87	117
	Inch	1.7	2.3	2.7	3.4	4.6
F	mm	67	86	112	129	176
	Inch	2.6	3.4	4.4	5.1	6.9
G	mm	93	125	143	180	242
	Inch	3.7	4.9	5.6	7.1	9.5

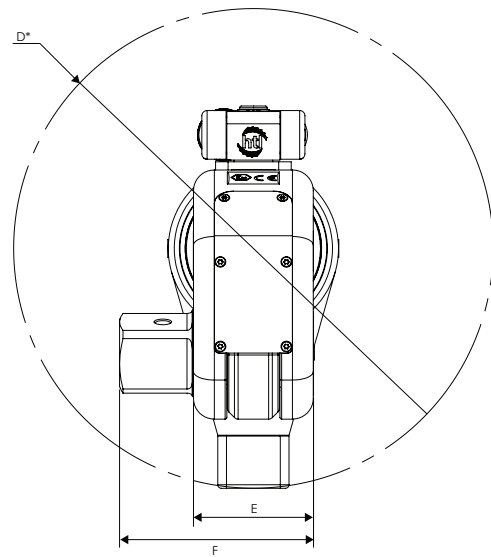
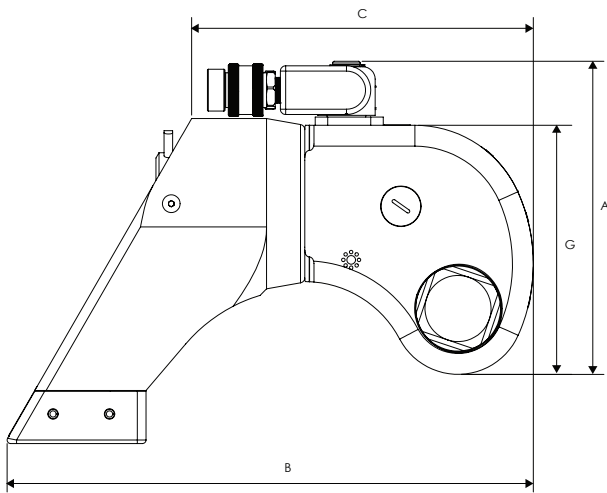

\*D = Reaction arm diameter

PLEASE NOTE: Figures provided are for guidance only, please refer to individual tool charts. All data is given in good faith and without acceptance of responsibility on the part of HTL.

## EXCELLENCE IN CONTROLLED BOLTING & FLUID POWER SOLUTIONS



HTL Group Ltd  
45 Colbourne Avenue,  
Nelson Park Industrial Estate,  
Cramlington, Northumberland,  
NE23 1WD



Telephone: +44 (0) 1670 700 000

Email: [info@htlgroup.com](mailto:info@htlgroup.com)

Visit: [www.htlgroup.com](http://www.htlgroup.com)

